



Puertas & Portones Automáticos, S.A. de C.V

*¡Nuestra pasión es la Solución!....*

» ENSAMBLE DE PUERTA RAPIDA ENROLLABLE AUTORREPARABLE MARCA BMP  
MOD.DYNAMICROLL.



# MANUAL DE INSTALACION



(229) 461-7028

portonesautomaticos@adsver.com.mx  
portonesautomaticos@prodigy.net.mx



V11.21

(229) 927-5107, 167-8080, 167-8007, 151-7529.



www.adsver.com.mx

## Summary

1. Preparation

2. Heading

3. Motor-reducer unit

4. Columns

5. Curtain

6. Wiring & Control Cabinet

# MANUAL DE INSTALACIÓN

## 1. PREPARATION

Before proceeding taking any action, make sure you have all the required parts and tools to perform the assembly.

### 1a. Required tools:

- |   |                                      |
|---|--------------------------------------|
| 1. Electric drill and a drill bits ( <i>d.9, 13 mm</i> ); | 9. Roll meter;                       |
| 2. Grinder;   | 10. Band saw;                        |
| 3. Square tool;   | 11. Scissors;                        |
| 4. Small straight head screwdriver;                       | 12. Hand air blower and roller;      |
| 5. Cross head screwdriver;                                | 13. PVC compatible fast action glue; |
| 6. Thread lock glue;                                      | 14. Rubber head hammer;              |
| 7. Metric wrench key set;                                 | 15. Wire stripping tool;             |
| 8. Allen key set;   | 16. Pen and calculator.              |

### 1b. Construction drawings:

- Log into BMP web-configurator to compile a quote for the desired size;
- Save to your PC both PDF files: for **frame** and **curtain** and print them.

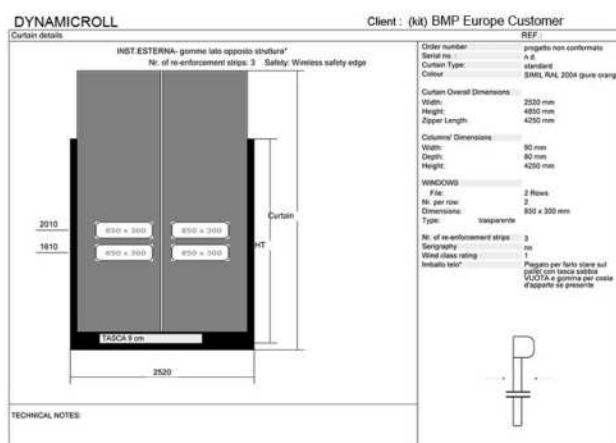
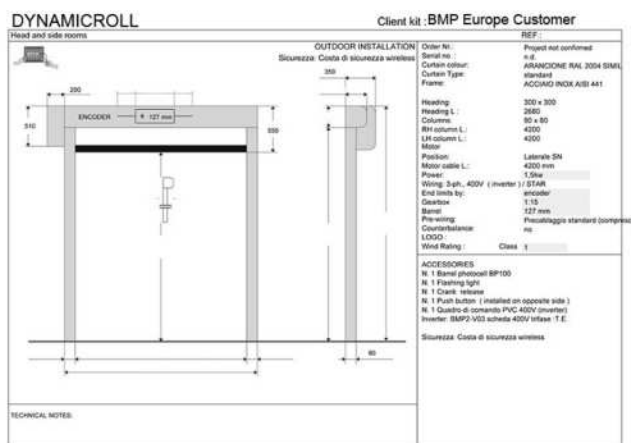



# MANUAL DE INSTALACIÓN

## 1c. Warehouse parts:

- a. Pick from the warehouse all the required parts to build a heading, which are as below. If an item is size dependable, select parts with minimum required length as per drawing.

*Note also the configuration of the door – some parts may not be required, such as safety sensor.*

- |   |   |
|---|---|
| 1. Heading back plate;                      | 11. Reducer fixation bracket;                   |
| 2. Heading front cover;                     | 12. Electric motor ( <i>note brake type</i> );  |
| 3. Aluminum tube;                           | 13. Safety micro-switch + 2 core cable;         |
| 4. Shaft: motor and bearing only side;      | 14. Motor cable;                                |
| 5. Shaft lock keys (3x);                    | 15. Motor cover;                                |
| 6. Bearing supports (2x);                   | 16. Encoder;                                    |
| 7. Side plate ( <i>motor side</i> );        | 17. Safety sensor ( <i>if required</i> );       |
| 8. Side plate ( <i>bearing only side</i> ); | 18. Spider cable ( <i>note required size</i> ); |
| 9. Fixation brackets (2x);                  | 19. Hand crank + socket;                        |
| 10. Reducer;                                | 20. Set of bolts, nuts etc.                     |



- b. For the curtain prepare the following:
1. Kit curtain with nearest required size;
  2. Kit zip, 2 pieces with required length;
  3. Empty sand bag;
  4. Kit tape switch for safety edge (*if required*).



# MANUAL DE INSTALACIÓN

## 2. HEADING

To ease overall process, it is advisable to perform the assembly on a table or on a mobile cart.



a. Take heading back cover and measure the required cut size. Do the same with front cover;

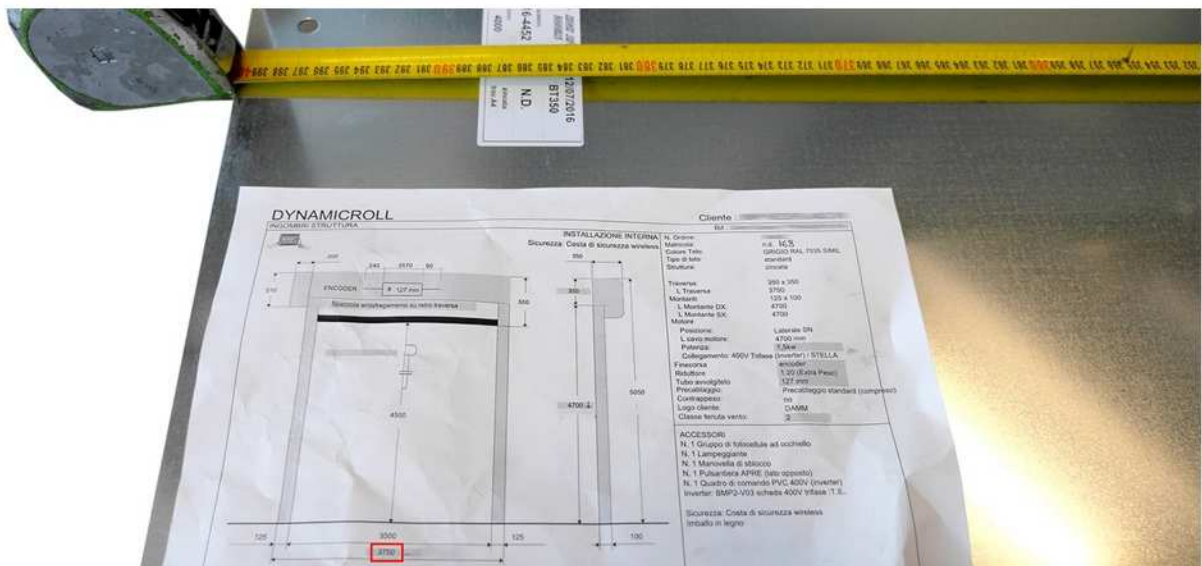



# MANUAL DE INSTALACIÓN

- b. Using a grinder, cut both parts;



- c. For both, back plate and front cover, cut out a 7 cm piece as shown below, to allow room for side plate;



- d. Using the square tool and a side plate, mark on the back cover where the holes are to be made;





# MANUAL DE INSTALACIÓN

- e. Drill 9 mm holes for each of three bolts;



- f. Take the aluminum brush holder and cut the required size with approx. 16 cm shorter than the length of the back cover.

Apply double-adhesive tape on its back. Placing it on the bottom part of the back cover as shown below, the distance between the edge of the cover and holder should be around 8 cm.



- g. Insert the 80 mm high brush into its holder and secure it on the edges with pliers.





# MANUAL DE INSTALACIÓN

h. Stick the brush to the heading back cover and secure it with rivets.



i. Prepare and assemble together the side plates, bearings and heading fixing brackets.





# MANUAL DE INSTALACIÓN

- j. Place the inner part of the motor cover on the outer face of side plate. Center it so the holes are all centered. Using self-drilling screws fix both together.



- k. Install the side plate for motor side only. DO NOT install the other side plate at this step.

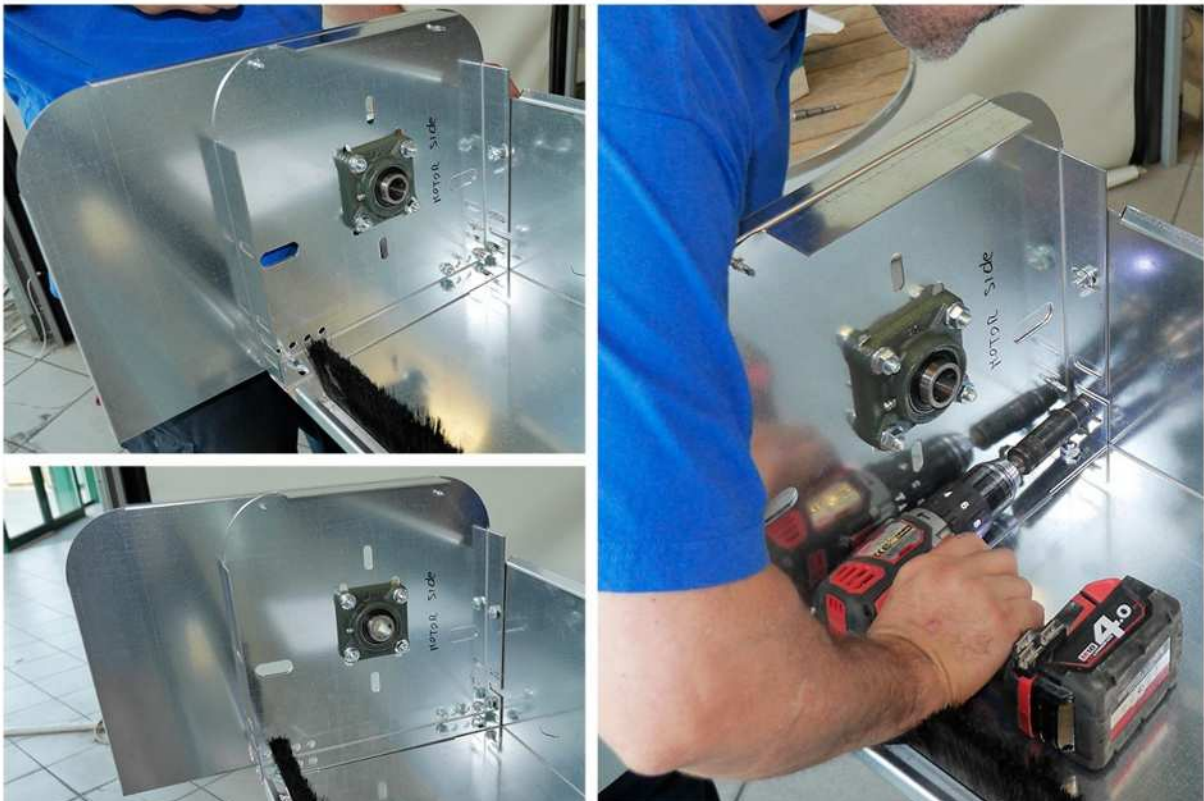



# MANUAL DE INSTALACIÓN

- l. Take the aluminum tube and cut it 40 mm shorter than the overall length of the heading. It has to fit flush between support bearings.



- m. Insert the shafts into the tube leaving out 40 mm for non-motor side and 185 mm for motor side. Prior inserting apply some thread lock glue as shown in the photos below.

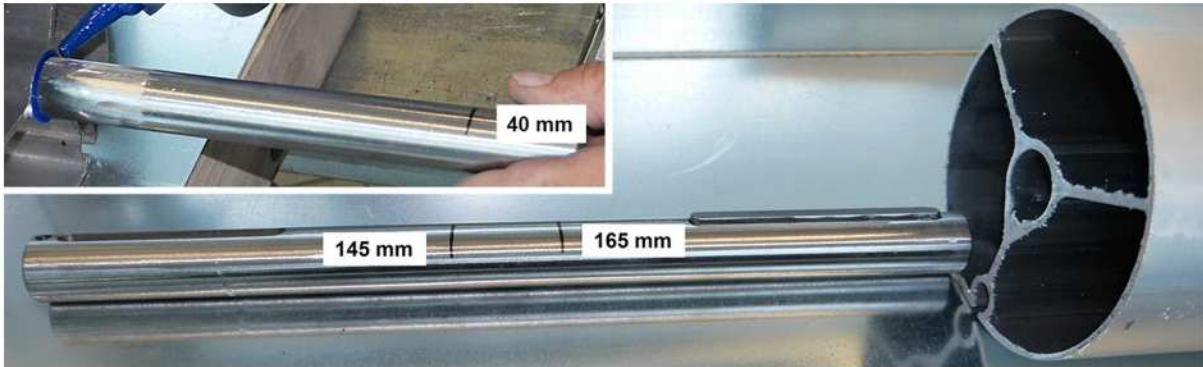

Note, some sanding and hammering may be required. Use a soft end hammer.





# MANUAL DE INSTALACIÓN

- n. Insert the barrel into the already installed side plate. Slightly tighten one of the two grub screws.



- o. On the other end on the barrel, install the side plate with bearing only and bolt it to the back cover of the heading. Carefully line-up the side plate to the back cover and tighten the bolts.



- p. Slightly tighten one of the two grub screws and lubricate both bearings, spinning in the meantime the barrel.



- q. In order to ensure correct safety sensor function, spray with black paint the inner part of the non-motor side plate as shown on the photos.





# MANUAL DE INSTALACIÓN



- r. Install the safety sensor (if required by configuration). Run through the pre-made holes the cable for both photocells.



- s. Install the front cover and fix it with three self-drilling screws on each side. One goes to the top and two side-by-sides on the bottom part. Make sure both side plates are flush to the top cover. Start fixation from the motor side first. Locking pliers may be required to temporarily fasten together loose parts.





# MANUAL DE INSTALACIÓN



## 3. MOTOR – REDUCER UNIT

- a. Place the motor on the reducer plate and bolt the reducer to the motor. To ease the process of inserting bolts, place the shaft key between the reducer and motor. After tighten them by hand.



- b. Use some thread lock glue and fix the reducer support plate to the reducer.



- c. Insert the motor-reducer unit on the barrel shaft and bolt the plate to the heading.





# MANUAL DE INSTALACIÓN

- d. Take a 30 cm two core cable and connect it to NC contacts of the Motor Safety Switch.



- e. Using two self-screwing nuts, fix the safety switch to the bottom fan cover of the motor.



- f. Insert the encoder into the barrel shaft and lock it with a grub screw. DO NOT use a hammer. Make sure to use thread lock glue for the grub screw. Bolt the encoder holder plate to the reducer.



- g. Connect the encoder to the "spider cable". Fasten "spider" hub cable to the reducer with a zip-tie.





# MANUAL DE INSTALACIÓN

- h. Run through corresponding gland motor cable and two core cable of the safety switch. Depending on door power supply type, connect motor windings either in star or delta using wiring diagram below. Brake power supply line is to be connected in series with the safety micro-switch.

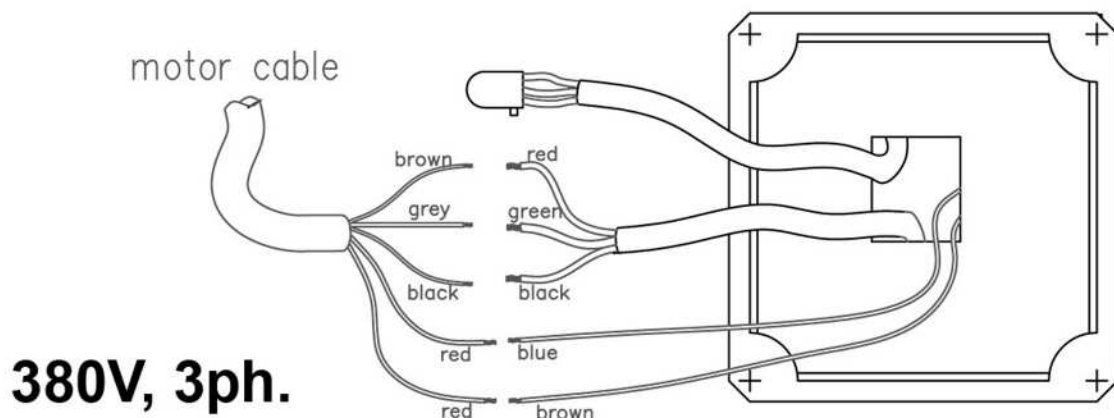
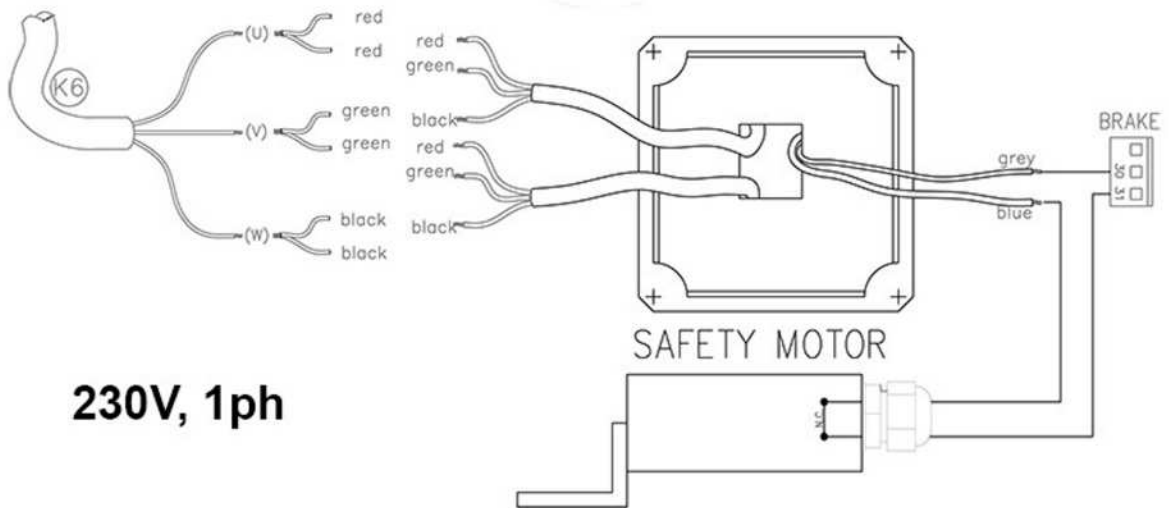
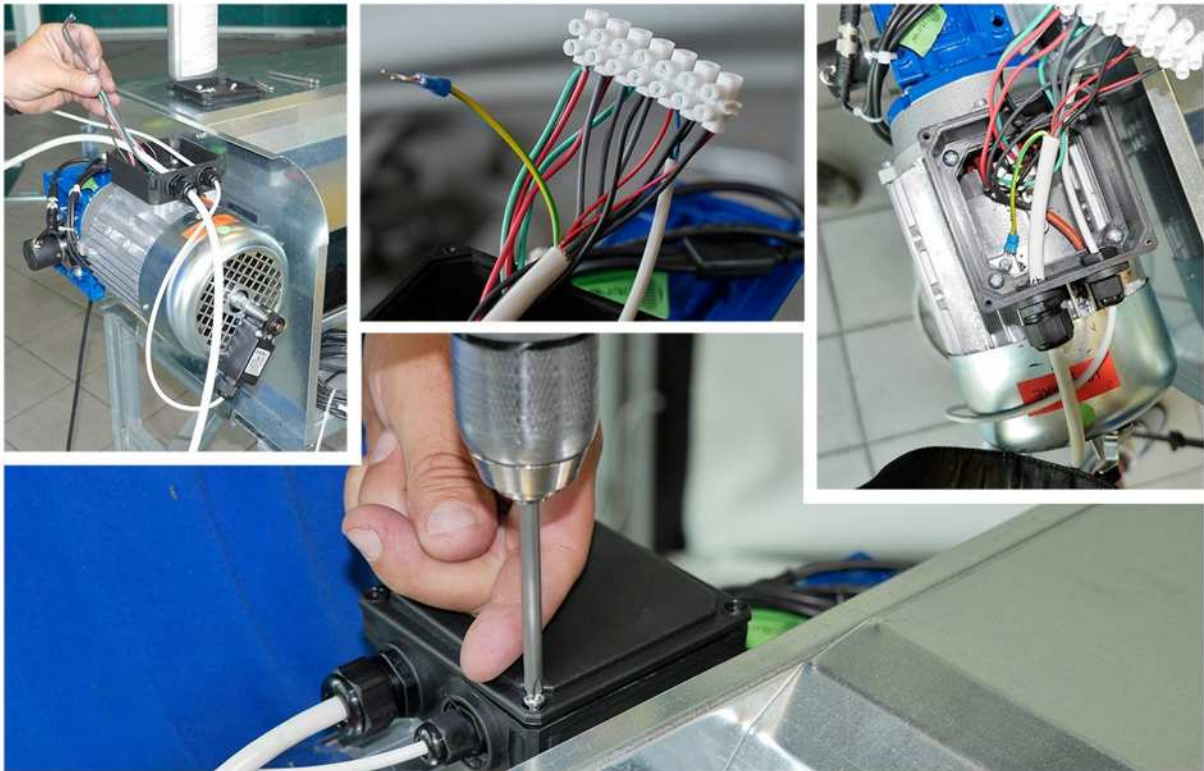

# MANUAL DE INSTALACIÓN

- i. Assemble the motor and install it onto the heading.



- j. Hand crank assembly. Note that doors with a clear opening higher than 4000 mm, do not usually come with a manual override hand crank.  
Take one hand crank and cut it, so its length is with 1500 mm shorter than the columns height.  
Drill a 4 mm hole and bolt the socket to it.

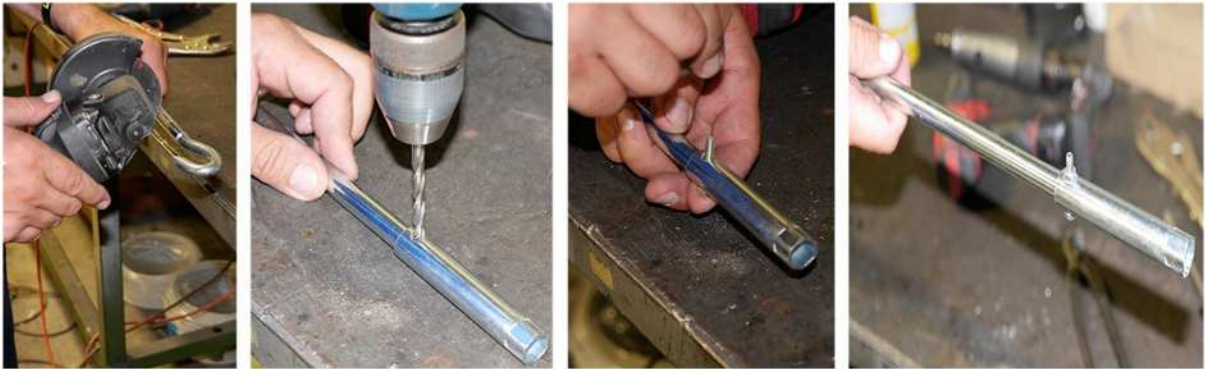



# MANUAL DE INSTALACIÓN

## 4. COLUMNS

- a. Remove the cover from the columns.

Take the base of the columns and cut to the required size from the top part of the column.

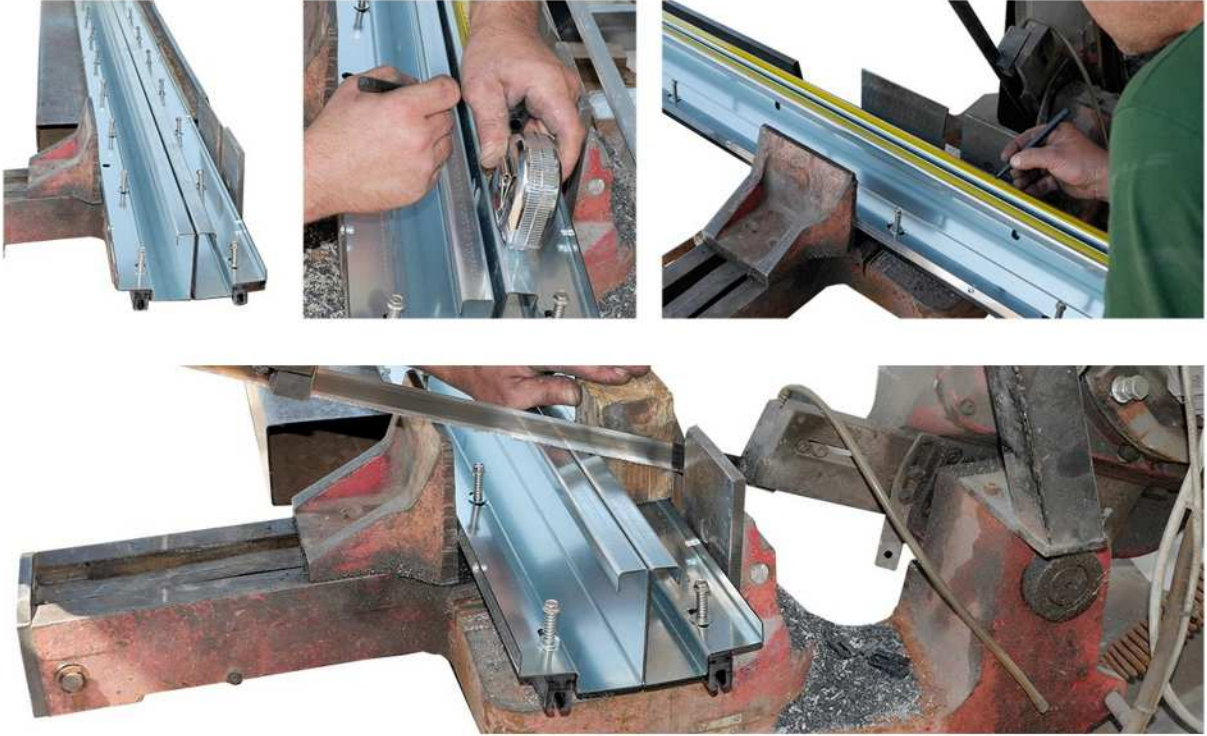

- b. Exactly as for column base, do the same for column covers .

Remember, the piece from the top is to be cut away.



# MANUAL DE INSTALACIÓN

- c. Using a screw driver or similar, push away the plastic guide. With a grinder shorten the guide with approx. 5-7 mm, so it does not touch the floor when mounted.



- d. Put the both covers back and fasten with bolts or self-drilling screws.





# MANUAL DE INSTALACIÓN

## 5. CURTAIN MANUFACTURING

For best results and shorter manufacturing time, it is recommended following works are done on a raised surface, such as a table. The dimensions do not necessary have to meet maximum available curtain size, but should be large or long enough to fit a folded or rolled curtain.

- a. Pick from warehouse close to the required size curtain and lay it on the floor.



- b. Measure overall curtain width and compare it to the required size shown on shop drawing.  
**Effective curtain width shall be = kit curtain width – 100 mm.**

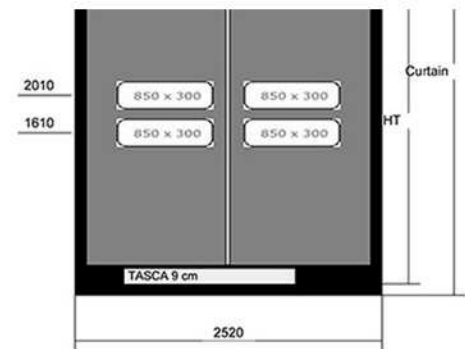

*\*Example: using photo and size above, effective curtain width without zip is  $2520 - 100 = 2420$  mm.*

# MANUAL DE INSTALACIÓN

- c. Find and mark middle of kit curtain. Referring to it, mark on each side half of the calculated width. Following above example it should be  $2420 / 2 = 2210$  mm. Using earlier made marks, draw a straight line on each side of the kit curtain.



- d. Re-check the sizes and cut away extra pieces.



- e. Take one roll of the zip kit and cut required length for each side of the curtain. Note the zip does not have to go all of the way to the end of the curtain. Cut it where the welding for the bottom flap starts.





# MANUAL DE INSTALACIÓN

- f. Align the zip kit to the curtain with black PVC strip below it. Recheck overall curtain width. If measured from the tip of the tooth to the other, the width shall be equal the one mentioned on shop drawing. To ease the process, temporarily fix the zip to the floor by means of adhesive tape or similar.

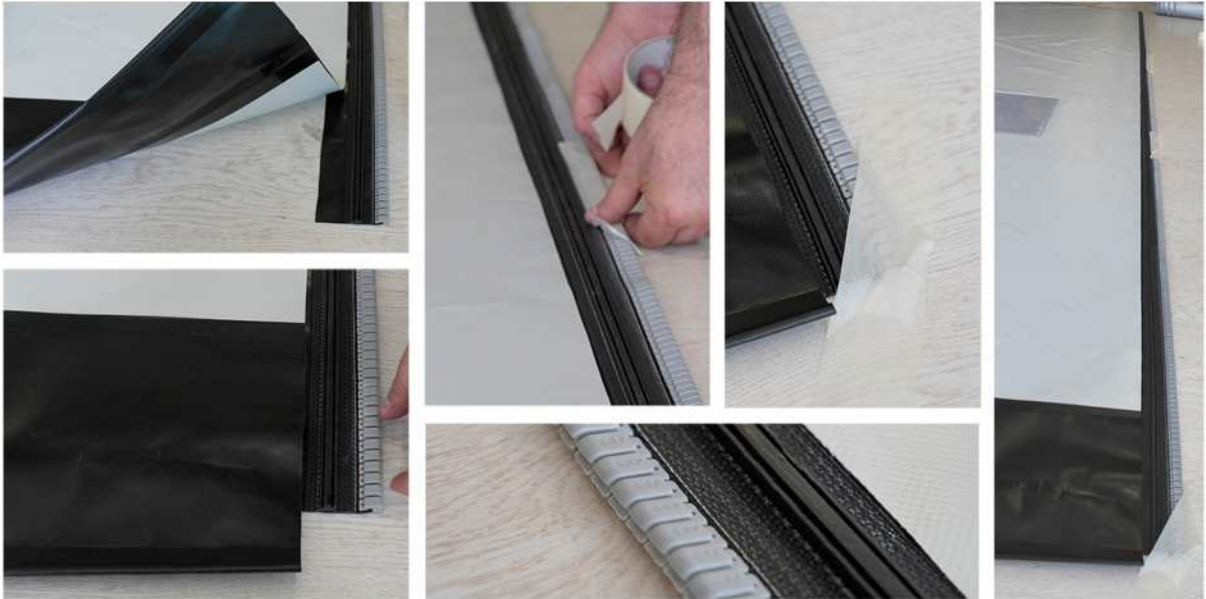

- g. If all the sizes are ok, it is advisable to glue the zip in several spots to the curtain. Thus when welding it will stay in place without the need to reposition it all the time.



- h. Take the hot air blower and the roller. Check the roller for any surface damages or PVC left overs. Clean it, if necessary. Turn on the air blower and set approx. 50% of its power capacity. Leave it on for a minute or two to reach set air temperature.



# MANUAL DE INSTALACIÓN

- i. Slightly raise the curtain and insert in-between the hot air blower. Pressing slightly the roller, roll it sideways; i.e. horizontally to the curtain, from center to its sides and backwards. Don't roll it along the zip, as you will likely to expand the PVC fabric and create wrinkles.



- j. When finished check if both sides were well welded to each other. If necessary carefully retouch the welding on each side of the curtain not overheating too much the PVC.



- k. Take an empty sand bag and cut it to a length shorter 400 mm then the curtain's overall width. Fill it with sand and seal the end with Loctite glue.





# MANUAL DE INSTALACIÓN

- I. Prepare the tape switch wire for safety edge, if present in the door configuration. The length of the rubber switch has to be 400 mm shorter than the curtain's overall width. Seal the joints between the rubber and end-caps with temperature shrinking tubes.



- m. Insert the tape switch into the designed space. While doing this, make sure the rubber tube does not twist and remains flat all the way through. Blowing some air inside will ease the process. When finished, fasten with a zip-tie connecting cable to the curtain.



- n. Insert the sand bag into the curtain. One side of the bottom flap seal using Loctite glue.



# MANUAL DE INSTALACIÓN

- o. Cut a piece of the Velcro tape and glue it on the open side of the bottom flap.



- p. Check if the curtain is in square and glue any required stickers on the curtain.





# MANUAL DE INSTALACIÓN

## 6. FINAL ASSEMBLY: FRAME + CURTAIN

- a. Remove heading cover and pull the curtain around the barrel. Position the curtain in the middle of the barrel and align it straight to the groove.



- b. Put the cover back on and screw it to the side plates.





Puertas & Portones Automáticos, S.A. de C.V.

*¡Nuestra pasión es la Solución!....*

» ENSAMBLE DE PUERTA RAPIDA ENROLLABLE AUTORREPARABLE MARCA BMP  
MOD.DYNAMICROLL.



Puertas & Portones Automáticos, S.A. de C.V.

*¡Nuestra pasión es la Solución!....*

(229) 461-7028

portonesautomaticos@adsver.com.mx  
portonesautomaticos@prodigy.net.mx



RESIDENCIAL



COMERCIAL



INDUSTRIAL

MEMBER



International Door Association



V11.21

(229) 927-5107, 167-8080, 167-8007, 151-7529.



www.adsver.com.mx